



伺服螺旋立式内拉床

LG8825NC-2000

Servo spiral vertical internal broaching machine

- 适用于螺旋花键内齿高精拉削
· Suitable for high-precision broaching of internal teeth of spiral spline
- 伺服驱动
· Servo drive
- 可快速切换不同规格螺旋花键和直齿花键的拉削
· The broaching of spiral spline and straight spline with different specifications can be quickly switched.

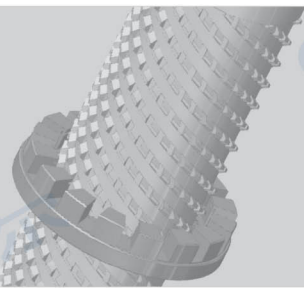

项目 ITEM	单位 UNIT	LG8825NC-2000
额定拉削力 Rated broaching force	kN	250
最大行程 Max.stroke	mm	2000
拉削速度 Broaching speed	m/min	1 ~ 7
返程速度 Return speed	m/min	1 ~ 12
适用拉刀长度 Applicable broach length	mm	1000 ~ 2100
最大工件外径 Max. workpiece outer diameter	mm	Φ250
主电机功率 Main motor power	kW	34
机床总功率 Total power	kW	60
机床外形 Machine tool shape	m	6×6.4×6.7
机床净重 Net weight	t	28